



SLIDE GATE VALVES SGM are designed for shutting off the material from hoppers, silos and rotary valves when maintenance of downstream equipment is requested.

SGM is suitable for a range of application thanks to its compact design. The blade self-cleaning after each opening ensures the valve a long durability.

APPLICATIONS

- GRAVIMETRIC FLOW
- POWDER
- GRANULE
- PELLETS
- MOCA – EC1935/2004

DESIGN

- SIZE: DN 150, DN 200, DN 250
- BODY: CASTING ALUMINIUM
- BLADE: SS304/SS316L
- OPERATION: MANUAL

FEATURES

- PRESSURE: ATM
- TEMPERATURE: MAX 100 °C
- NARROW PROFILE
- FREE OPENING
- HORIZONTAL AND VERTICAL INSTALLATION
- LONG LIFE

OPTIONALS

- SPECIAL EXECUTION FOR ABRASIVE PRODUCT
- MATERIAL ACCORDING WITH EC1935/2004
- CUSTOM SIZE

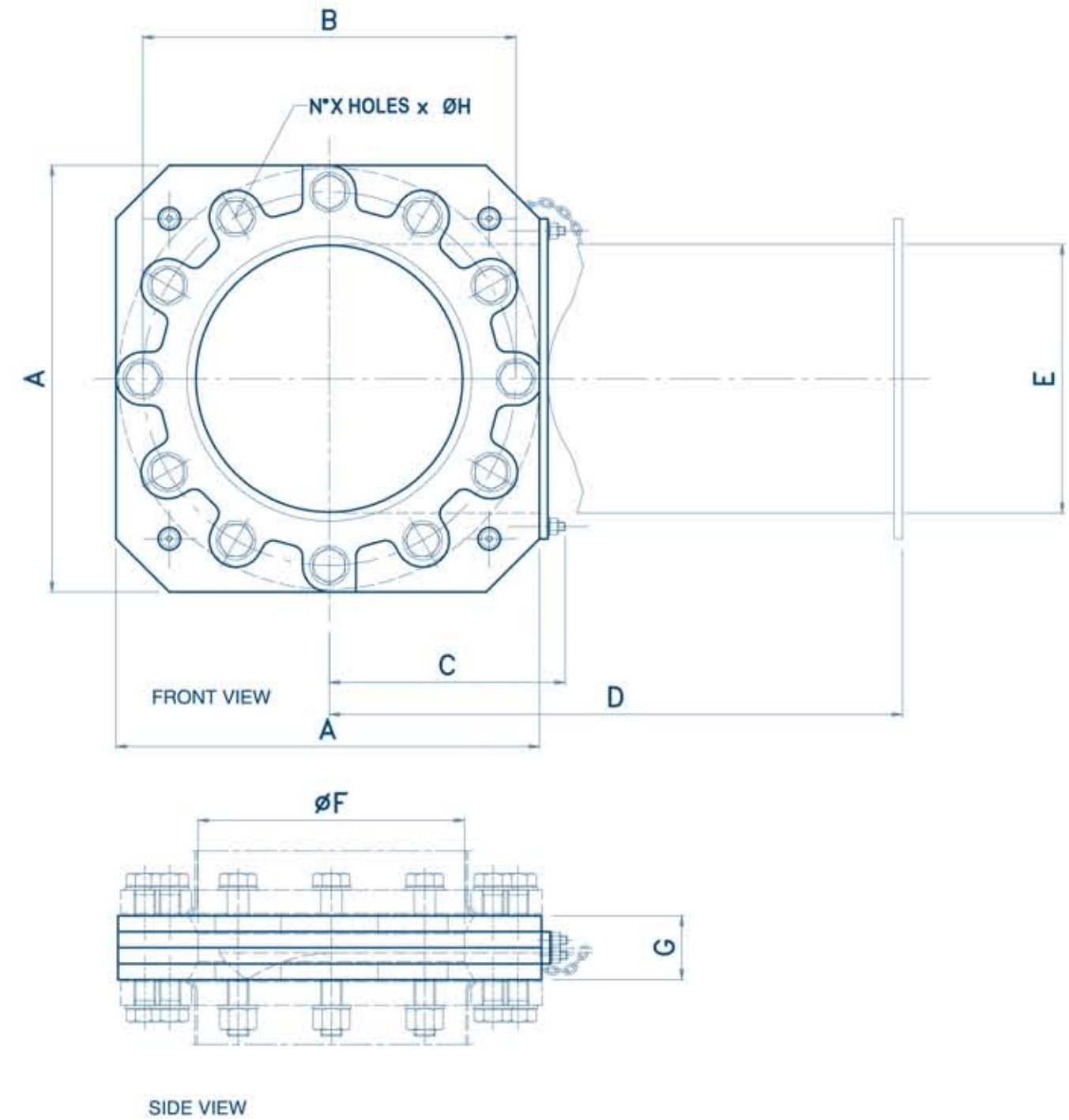

	A	B	C	D	E	F	G	I x ML
150	285	Ø240	180	406	160	Ø156	58	8 x Ø22
200	340	Ø295	208	484.5	205	Ø200	64	8 x Ø22
250	400	Ø350	237	568	264	Ø250	60	12 x Ø22

BROCHURE



COMPLIANCE

