

SVR NT Project 1

SVR NT BELT CONVEYOR

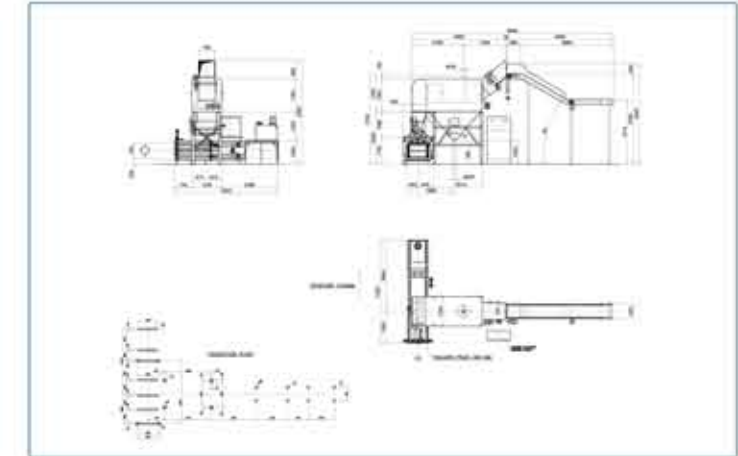

TECHNICAL NOTES

SCOPE OF SUPPLY: *filling silos*

CUSTOMER'S NEED: *minimal damage on shell of the seed*

FLOWRATE: *10 tons/h*

MATERIAL: *various seeds*

KIND OF BAG: *paper*

MATERIAL SUPPLIED: *on pallet*

EQUIPMENT: *SVR 600 with belt conveyor and special Tilting&Lifting Board*

SVR NT Project 2

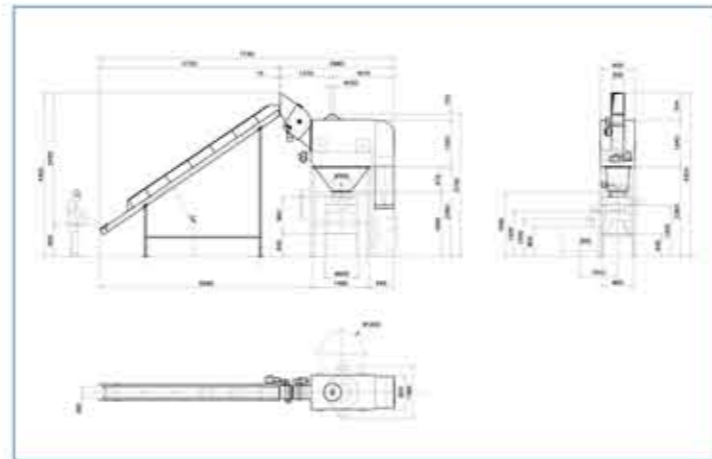

TECHNICAL NOTES

SCOPE OF SUPPLY: coffee recycling

CUSTOMER'S NEED: recover coffee wrapping

FLOWRATE: 1 tons/h

MATERIAL: coffee powder

KIND OF WRAPPING: from 1 to 5 Kg

MATERIAL SUPPLIED: free bag

EQUIPMENT: special SVR150 with belt conveyor

SVR NT Project 3

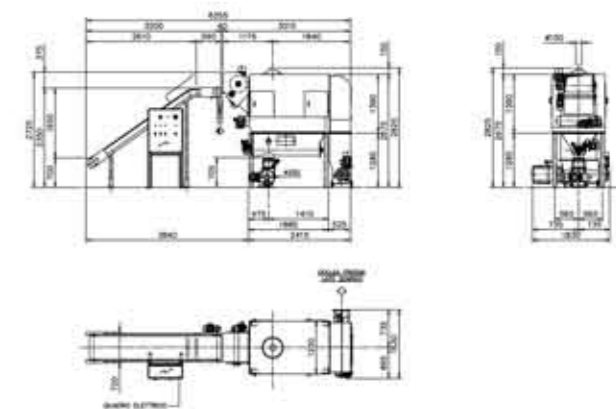

TECHNICAL NOTES

SCOPE OF SUPPLY: filling silos

CUSTOMER'S NEED: limited available space but request high throughput, easy working, no residual inside machine, easy cleaning

FLOWRATE: 9 tons/h

MATERIAL: plastic granule with different colors

KIND OF BAG: plastic

MATERIAL SUPPLIED: free bag

EQUIPMENT: SVR 300 with belt conveyor and special design for easy cleaning

SVR NT Project 4

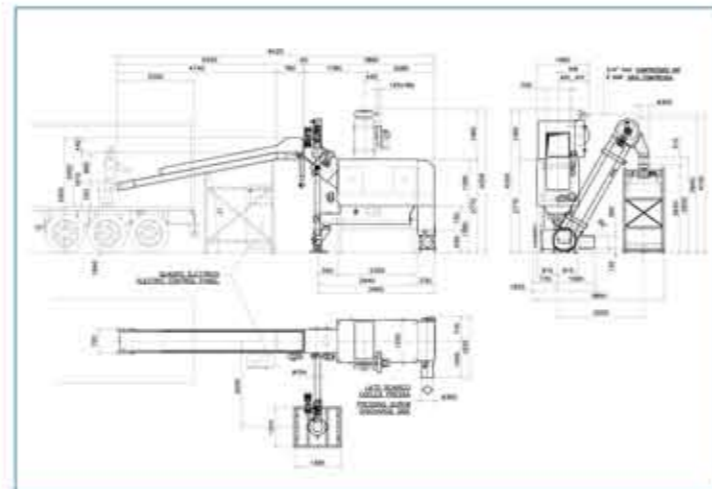

TECHNICAL NOTES

SCOPE OF SUPPLY: filling big bag

CUSTOMER'S NEED: direct loading by truck trough belt conveyor, atex execution

FLOWRATE: 10 tons/h

MATERIAL: sugar

KIND OF BAG: paper/plastic

MATERIAL SUPPLIED: free bag

EQUIPMENT: SVR 600 with special belt conveyor, mechanical conveyor and FIBC

SVR NT Project 5

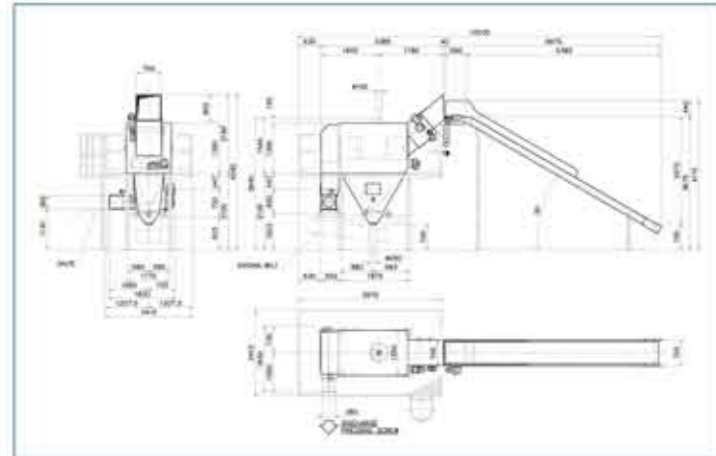

TECHNICAL NOTES

SCOPE OF SUPPLY: filling silos

CUSTOMER'S NEED: minimal damage on material, low maintenance, long-life blade, high emptying coefficient

FLOWRATE: 10 tons/h

MATERIAL: various seeds

KIND OF BAG: paper with different dimensions and filling per bag

MATERIAL SUPPLIED: free pallet

EQUIPMENT: SVR 600 with belt conveyor

SVR NT Project 1

SVR NT BELT CONVEYOR

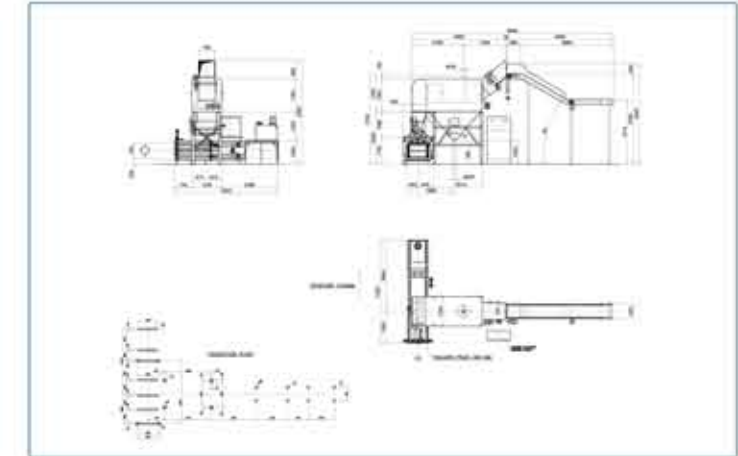

TECHNICAL NOTES

SCOPE OF SUPPLY: *filling silos*

CUSTOMER'S NEED: *minimal damage on shell of the seed*

FLOWRATE: *10 tons/h*

MATERIAL: *various seeds*

KIND OF BAG: *paper*

MATERIAL SUPPLIED: *on pallet*

EQUIPMENT: *SVR 600 with belt conveyor and special Tilting&Lifting Board*

SVR NT Project 2

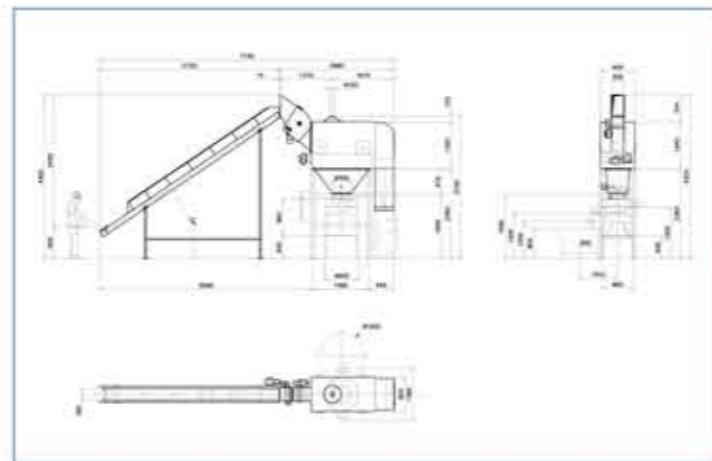

TECHNICAL NOTES

SCOPE OF SUPPLY: coffee recycling

CUSTOMER'S NEED: recover coffee wrapping

FLOWRATE: 1 tons/h

MATERIAL: coffee powder

KIND OF WRAPPING: from 1 to 5 Kg

MATERIAL SUPPLIED: free bag

EQUIPMENT: special SVR150 with belt conveyor

SVR NT Project 3

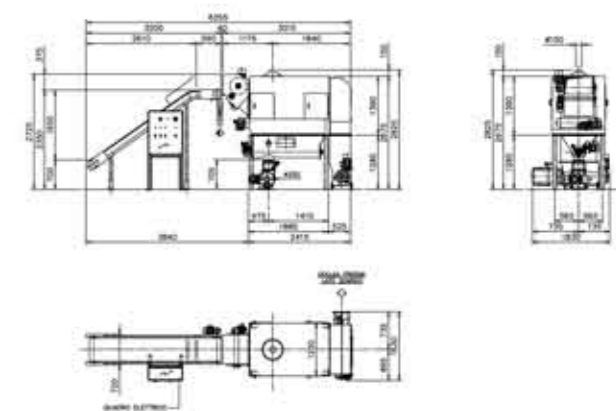

TECHNICAL NOTES

SCOPE OF SUPPLY: filling silos

CUSTOMER'S NEED: limited available space but request high throughput, easy working, no residual inside machine, easy cleaning

FLOWRATE: 9 tons/h

MATERIAL: plastic granule with different colors

KIND OF BAG: plastic

MATERIAL SUPPLIED: free bag

EQUIPMENT: SVR 300 with belt conveyor and special design for easy cleaning

SVR NT Project 4

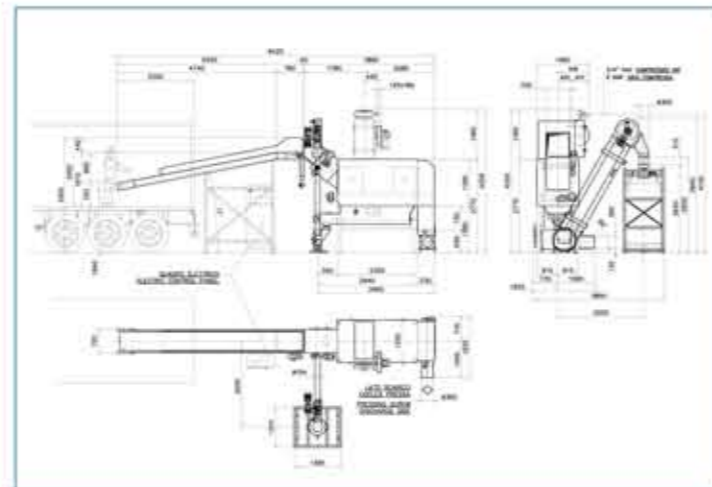

TECHNICAL NOTES

SCOPE OF SUPPLY: *filling big bag*

CUSTOMER'S NEED: *direct loading by truck trough belt conveyor, atex execution*

FLOWRATE: *10 tons/h*

MATERIAL: *sugar*

KIND OF BAG: *paper/plastic*

MATERIAL SUPPLIED: *free bag*

EQUIPMENT: *SVR 600 with special belt conveyor, mechanical conveyor and FIBC*

SVR NT Project 5

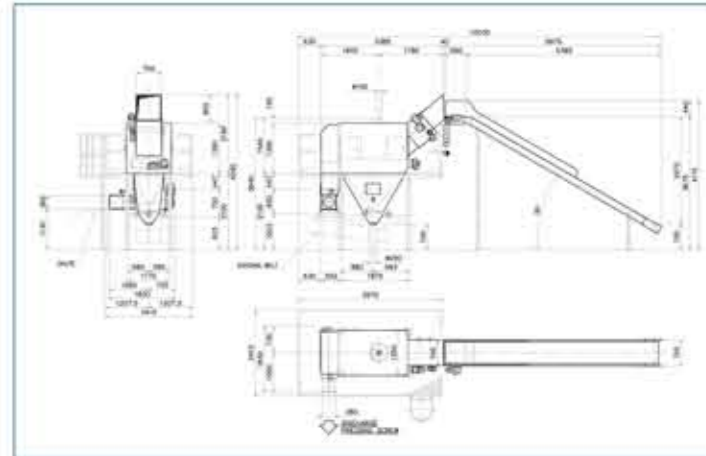

TECHNICAL NOTES

SCOPE OF SUPPLY: *filling silos*

CUSTOMER'S NEED: *minimal damage on material, low maintenance, long-life blade, high emptying coefficient*

FLOWRATE: *10 tons/h*

MATERIAL: *various seeds*

KIND OF BAG: *paper with different dimensions and filling per bag*

MATERIAL SUPPLIED: *free pallet*

EQUIPMENT: *SVR 600 with belt conveyor*